

NEWLINE

High Quality Visual Display Products

Newline
2901 Technology Dr Ste 135
Plano, TX 75074
T: 972.881.3318
F: 972.881.0985

INSTALLATION INSTRUCTIONS

Recessed Display Case

Lighting not Included

IMPORTANT! If installing multiple cases verify you have the correct case matched to the correct location! If you are unsure, STOP, and contact Newline for assistance.

BEFORE YOU BEGIN

- 1) Read and be sure you understand these instructions; keep them for reference.
- 2) Inventory all parts and pieces including glass shelves, shelving standards, doors and locks. Extra shelves are included with most shipments.
- 3) Verify that the rough opening is the correct dimension for the case you are going to install in that location.

Instructions

1. Insert the empty case (without shelves or brackets) into the opening. (See Fig. 1)
2. Secure the case in place with the appropriate fasteners.
3. Screw through the U-Channel of the left and right side door track into the perimeter of the rough opening. Fasteners should be located about 1" apart. (See Fig. 2)
4. Install the glass shelving brackets and shelves.
5. Install the doors and locks. Test to ensure they work smoothly.
6. Use a soft dry cloth to remove any marks or smudges.

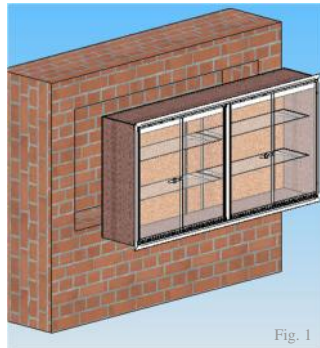

Fig. 1

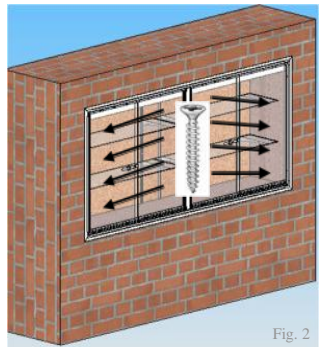
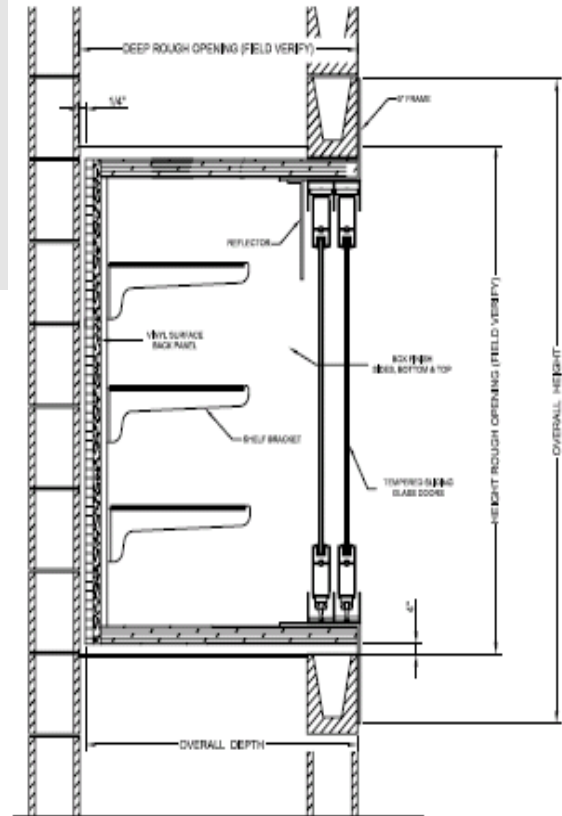
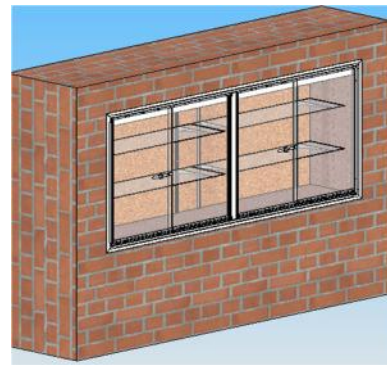

Fig. 2



INSTALL IS COMPLETE



Please report any missing or damaged parts immediately!